

# User Guide: *Profile 2025* Online Report

Welcome to the new online report for *Profile 2025*. This guide will help you navigate the fully bilingual website and access our interactive data on both desktop and mobile devices.

## Desktop navigation

**Language selection:** The website is fully bilingual. You can easily switch the site between English and French by clicking the **EN / FR** toggle at the top left of the homepage.



Switch the site between English and French by clicking the EN / FR toggle at the top left of the homepage.

**Browsing chapters:** Use the **navigation menu** on the left-hand side of the page to browse all 12 chapters of *Profile*. Simply scroll through the menu, **select** a chapter, and **choose** a sub-chapter to view its contents.

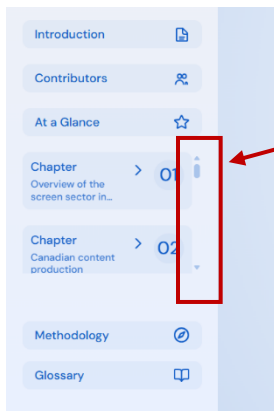

Scroll through the menu, select a chapter, and choose a sub-chapter to view its contents.

**Footnotes:** Any footnotes related to the text can be found at the very bottom of each sub-chapter page.

## Interactive data and graphs (desktop)

**Hover for details:** All graphs are interactive. **Hover** your cursor over specific elements, such as a year or region, to find detailed information for that category.

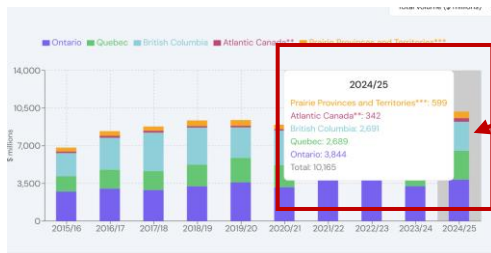

Hover your cursor over specific elements, such as a year or region, to find detailed information for that category.

**Multiple datasets:** If you see a box with a **drop-down arrow** in the top right corner of a graphic, it indicates that multiple datasets are available. **Click** the arrow to toggle between different views, such as "total volume (\$)" or "share of total (%)"



Click the drop-down arrow to toggle between different views, such as "total volume (\$)" or "share of total (%)"

## Mobile experience

**Mobile menu:** To navigate, **tap** the menu icon (a small box with three horizontal lines) in the upper right-hand corner of your screen.

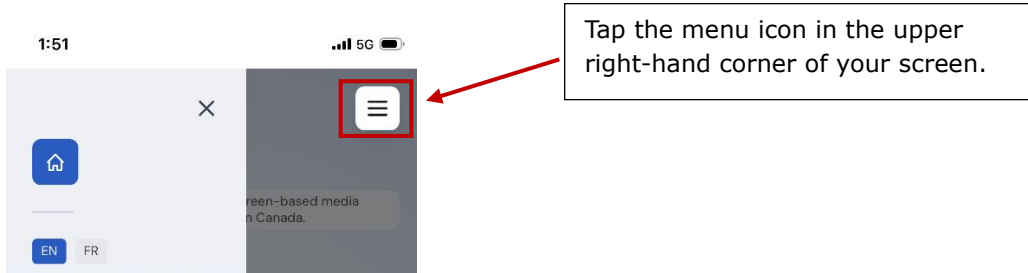

**Selecting sub-chapters:** In the navigation menu, **tap** on a chapter to view its sub-chapters, then **select** a sub-chapter to load the full content onto your screen. Whenever you want to switch to a different section, simply **tap** the screen to make the menu icon reappear.

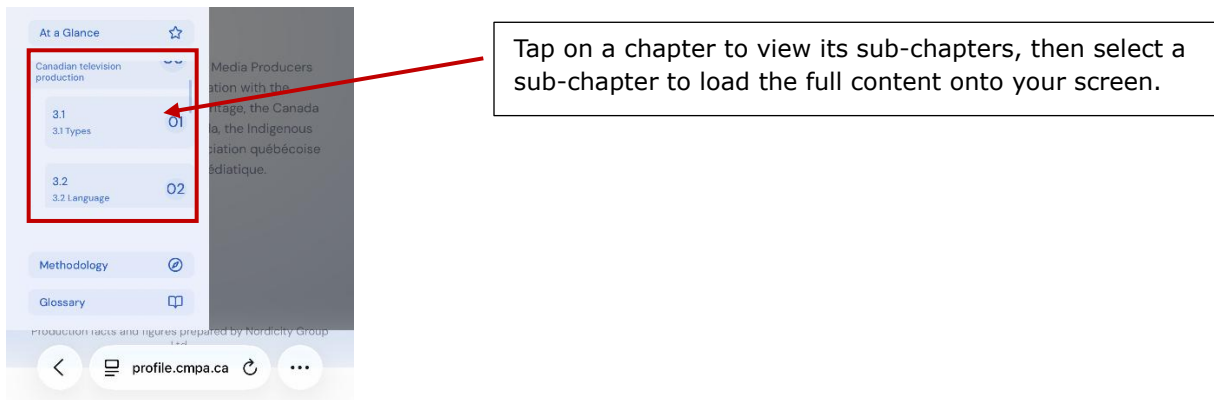

**Viewing tables:** While content is optimized for your device, you will need to **swipe horizontally** with your finger on any data tables to view the complete set of information.

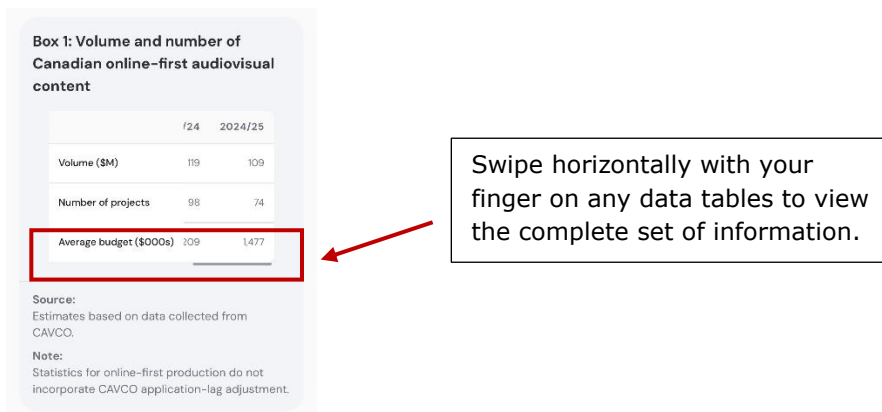

## Interactive data and graphs (mobile)

**Tap for details:** Graphs are interactive. Use your finger to **tap** on bar graphs, or points on line graphs, to find detailed information for that category.



Tap on bar graphs, or points on line graphs, to find detailed information for that category

**Multiple datasets:** If you see a box with a **drop-down arrow** in the top right corner of a graphic, it indicates that multiple datasets are available. **Click** the arrow to toggle between different views, such as "by language" or "by genre".



Click the arrow to toggle between different views, such as "by language" or "by genre".